

FOR WATERPROOFING ICF FOUNDATIONS

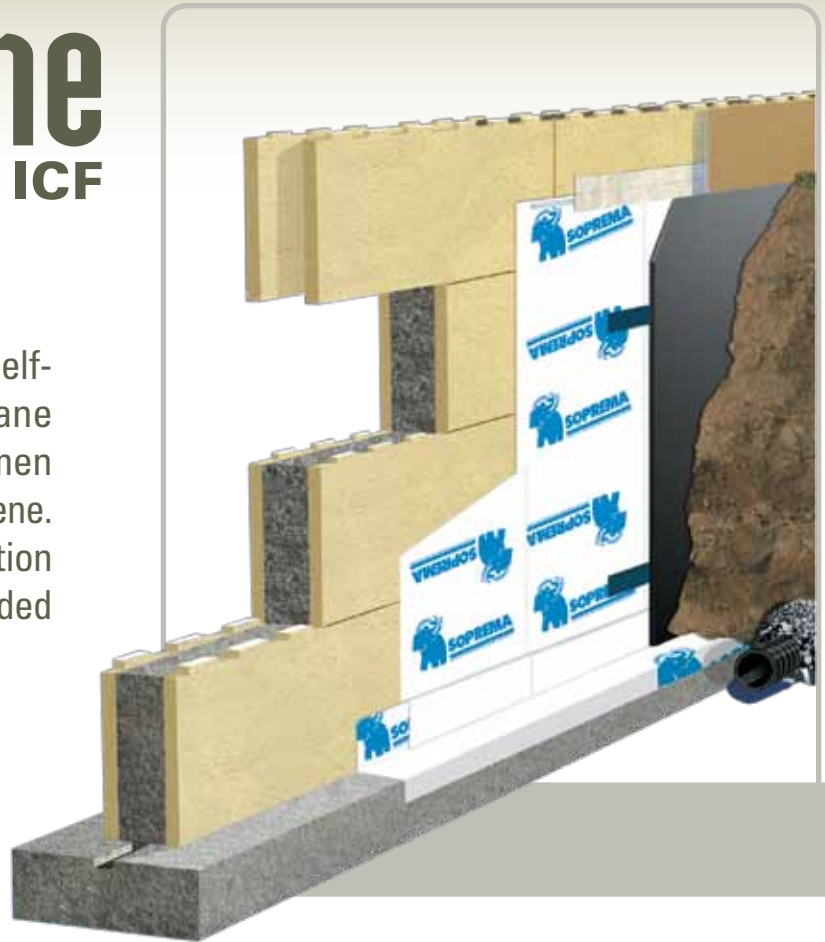

COLPHENE ICF is a high quality self-adhesive waterproofing membrane composed of SBS modified bitumen and a tri-laminate woven polyethylene. The membrane is ideal for application on ICF formwork systems or extruded polystyrene substrates.



SURFACE PREPARATION

Clean, dry surfaces generally do not require priming. However, if specific conditions call for the use of primer, SOPREMA strongly recommends a water-based primer such as ELASTOCOL STICK H₂O.

COLPHENE ICF

Thickness ■ 40 mils (1 mm)

Dimension ■ 36 in x 75 ft (0.91 m x 22.9 m)

A silicone release sheet protects the self-adhesive side.

ADVANTAGES

- CONSISTENT THICKNESS
- SUPERIOR FLEXIBILITY
- HIGH TENSILE STRENGTH
- HIGH PUNCTURE RESISTANCE
- PRE-CUT ROLLS AVAILABLE

SOPRAGRIP F is a self-adhesive membrane composed of SBS modified bitumen and a non-woven polyester exposed reinforcement. It is used as a cover strip over COLPHENE ICF membranes top termination. The membrane is also used as reinforcement over gypsum or concrete boards.

INSTALLATION INSTRUCTIONS

1



INSTALL

the footing membrane first, making sure that the inside corner is completely adhered.

2



PEEL BACK

the top part of the silicone release film.

3



ADHERE

the top edge of the COLPHENE ICF membrane, making sure the membrane is well aligned.

4



GRADUALLY PEEL BACK

the remaining silicone release film, making sure the membrane is completely adhered.

5



THE USE OF A ROLLER

is strongly recommended to remove air pockets.

6



MEMBRANE'S TOP TERMINATION

must be sealed with SOPRAGRIP F or a mastic/sealant such as SOPRASEAL LM 200T. The use of a termination bar mechanically fastened to ICF is recommended at membrane's top termination.

Backfill: In areas where pit-run sand is not available, a protective board is recommended to ensure the integrity of the waterproofing membrane.

If you have any questions about this product or its installation, please contact your SOPREMA representative.



SOPREMA contributes to environmental protection and sustainable construction by manufacturing high quality products that meet the highest environmental standards. The Ginkgo Biloba leaf is the symbol selected by Soprema to represent its ecological commitment.



COLPHENE ICF

TECHNICAL DATA SHEET
130104SCAN1E
(supersedes 110420SCAN1E)

DESCRIPTION

COLPHENE ICF is a self-adhesive waterproofing membrane dedicated to the waterproofing of Insulated Concrete Forms (ICF) foundations. It is composed of SBS modified bitumen and a polyethylene woven complex. A silicone release paper protects the adhesive side.

COLPHENE ICF can be applied directly to the polystyrene (expanded and extruded) surface of ICF foundations. Clean, dry and even surfaces generally do not require priming. If specific conditions call for the use of primer, such as dusty work sites, Soprema recommends using its water-based primer **ELASTOCOL STICK H₂O**. Solvent-based primers may damage polystyrene and therefore must not be used.

Application temperatures: Winter Grade: -10 to 40 °C (14 to 104 °F)
Summer Grade: 10 to 50 °C (50 to 122 °F)

Application temperatures: Winter and Summer Grades: -10 to 40 °C (14 to 104 °F)

INSTALLATION

If needed, apply **ELASTOCOL STICK H₂O** primer at the rate of 0.1 to 0.3 L/m². Allow drying completely before application of the membrane. Membrane must be applied the same day as the application of primer.

The top edge of the membrane and where the membrane meets with the concrete footing, it must be sealed with a mastic/sealant such as **SOPRASEAL LM 200 T** which is compatible with polystyrene. For rocky soil, a protection board (e.g. **SOPRABOARD**, etc.) must be installed prior to backfilling.

PLEASE CONSULT SOPREMA FOR COMPLETE INFORMATION ON APPLICATION AND SYSTEMS.

PROPERTIES

Properties	Standards	COLPHENE ICF
Thickness	-	1.0 mm (40 mils)
Dimensions	-	22.9 x 0.91 m (75 ft x 36 in)
Gross / Net coverage per roll	-	20.8 / 19.1 m ² (225 / 206 ft ²)
Roll Weight	-	20 kg (44 lb)
Surface	-	Tri-laminated woven polyethylene
Underface	-	Silicone release film
Tensile Strength, MD/XD	ASTM D5147	11.3 / 15.4 kN/m (64 / 88 lbf/in)
Ultimate Elongation, MD/XD	ASTM D5147	52 / 24 %
Flexibility at Cold Temperature	ASTM D5147	-30 °C (-22 °F)
Static Puncture	ASTM D5602	400 N (90 lbf)
Tear Resistance, MD/XD	ASTM D1876	375 / 400 N (85 / 90 lbf)
Lap Adhesion	ASTM D1876	2000 N/m (11.4 lbf/in)
Peel Resistance	ASTM D903	3050 N/m (17.5 lbf/in)
Water Absorption	ASTM D5147	< 0.1 %
Water Vapour Permeance	ASTM E96 (Procedure B)	< 0.90 ng/Pa.s.m ² (< 0.016 perm)
Termite Resistance	See Trinity/ERD report # S10030SC.04.08	Passed

(All values are nominal)

LIMITATION

COLPHENE ICF is designed to be used as waterproofing membrane in below grade application only. It must not be used in above grade application. Membrane must be covered and backfilled after installation is completed.

